

AI-GENERATED TEST ASSIGNMENT

For Faculty Member

1

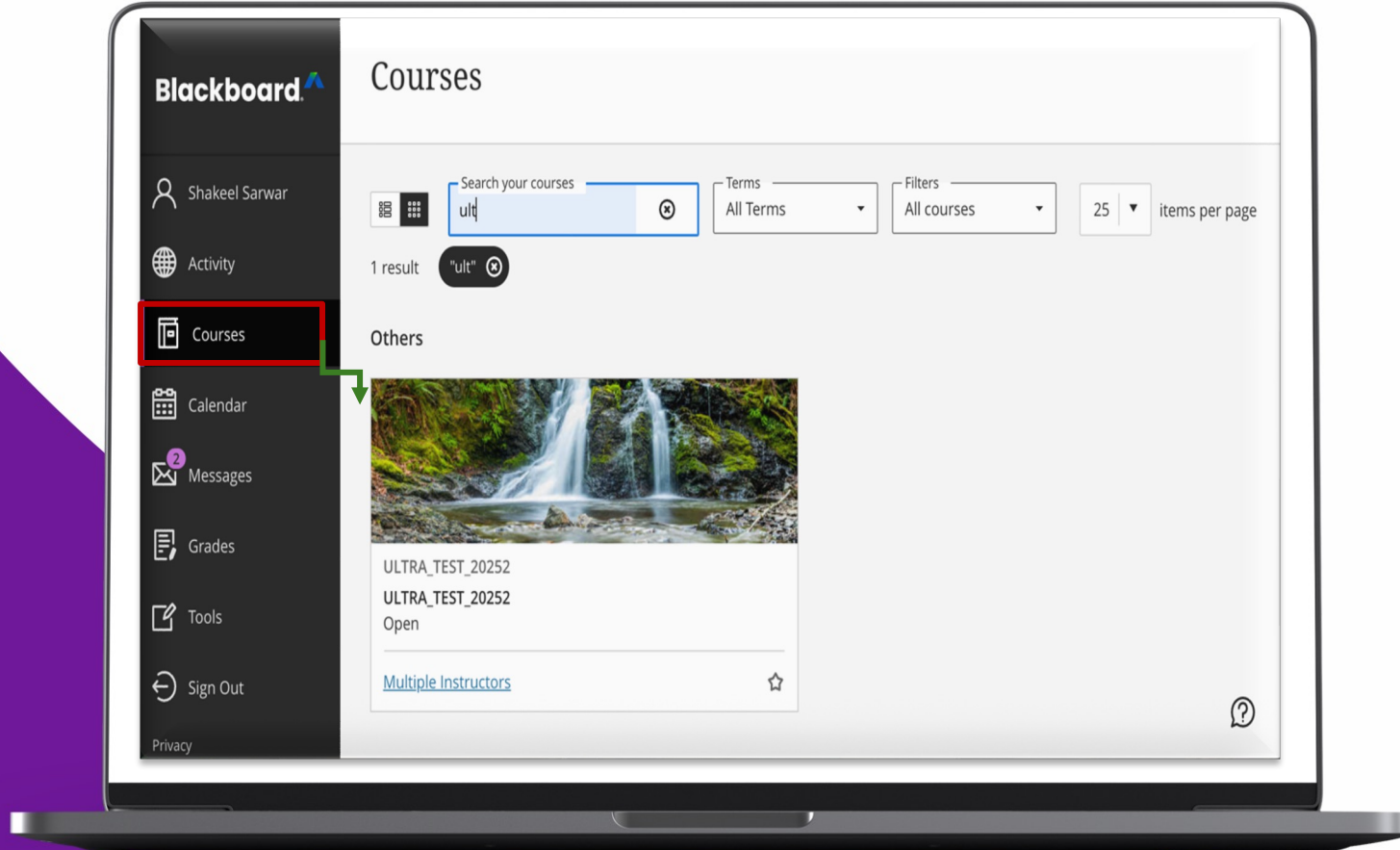

Open Course

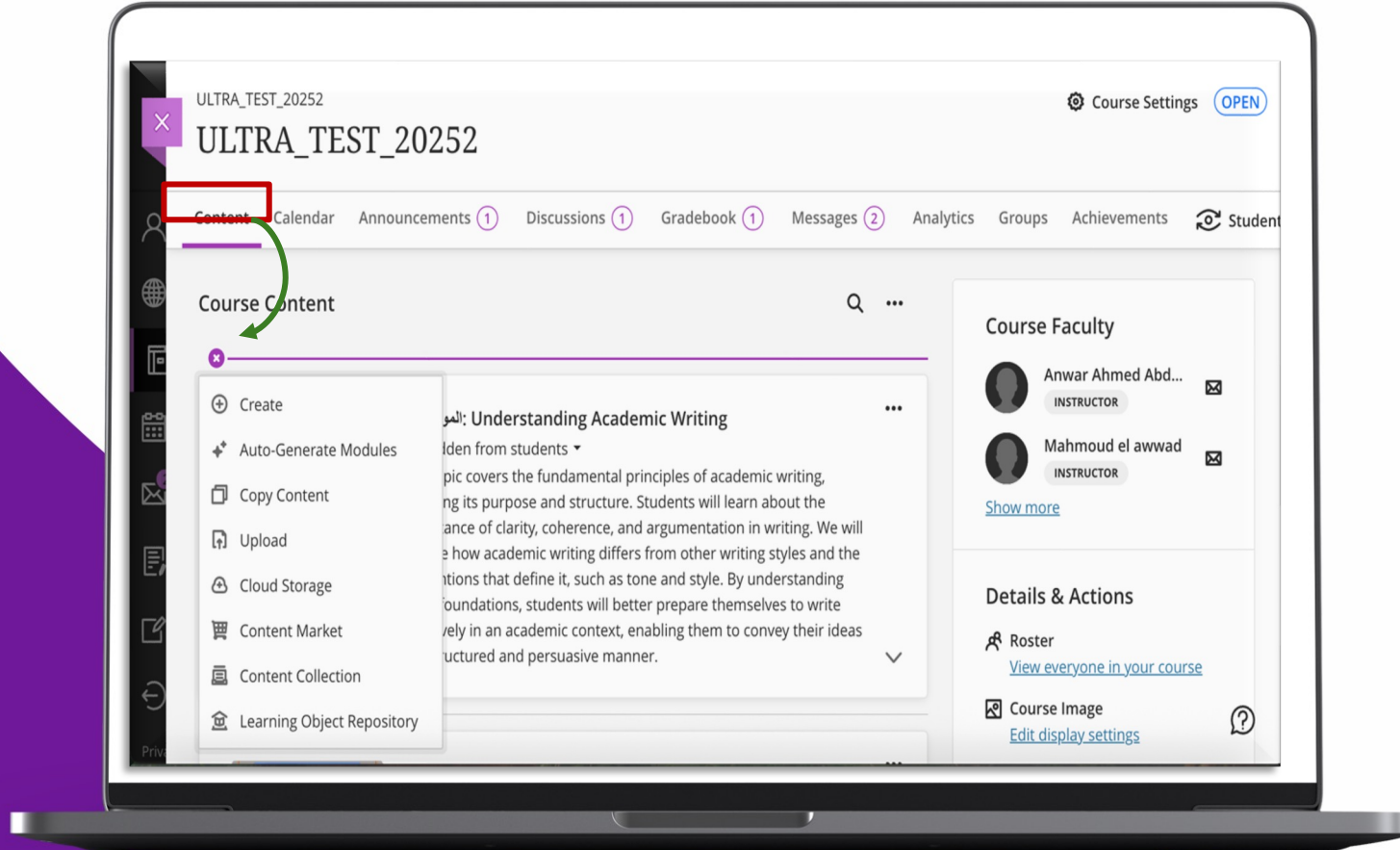

**Click on + Sign, then
Create**

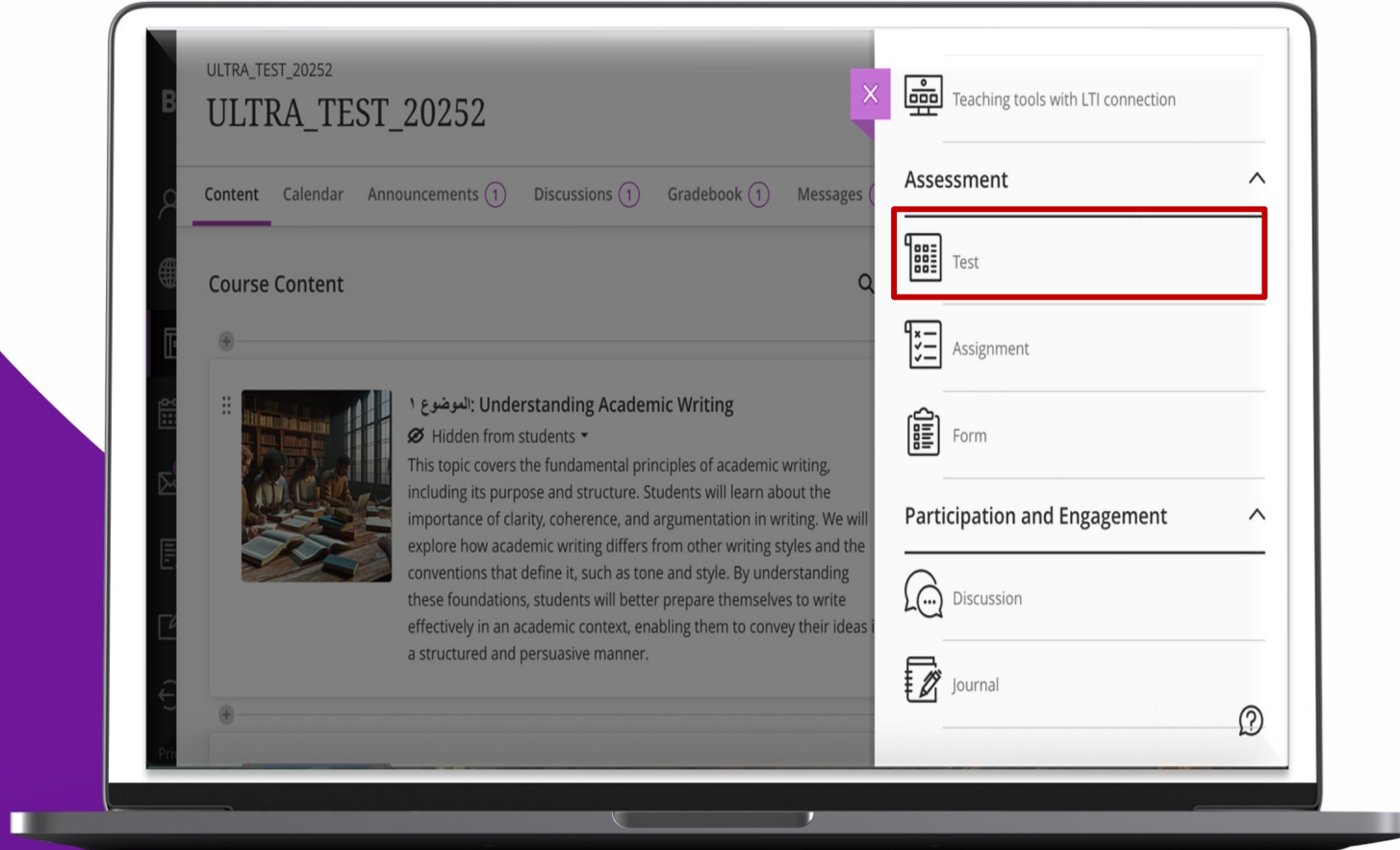

Click on Test

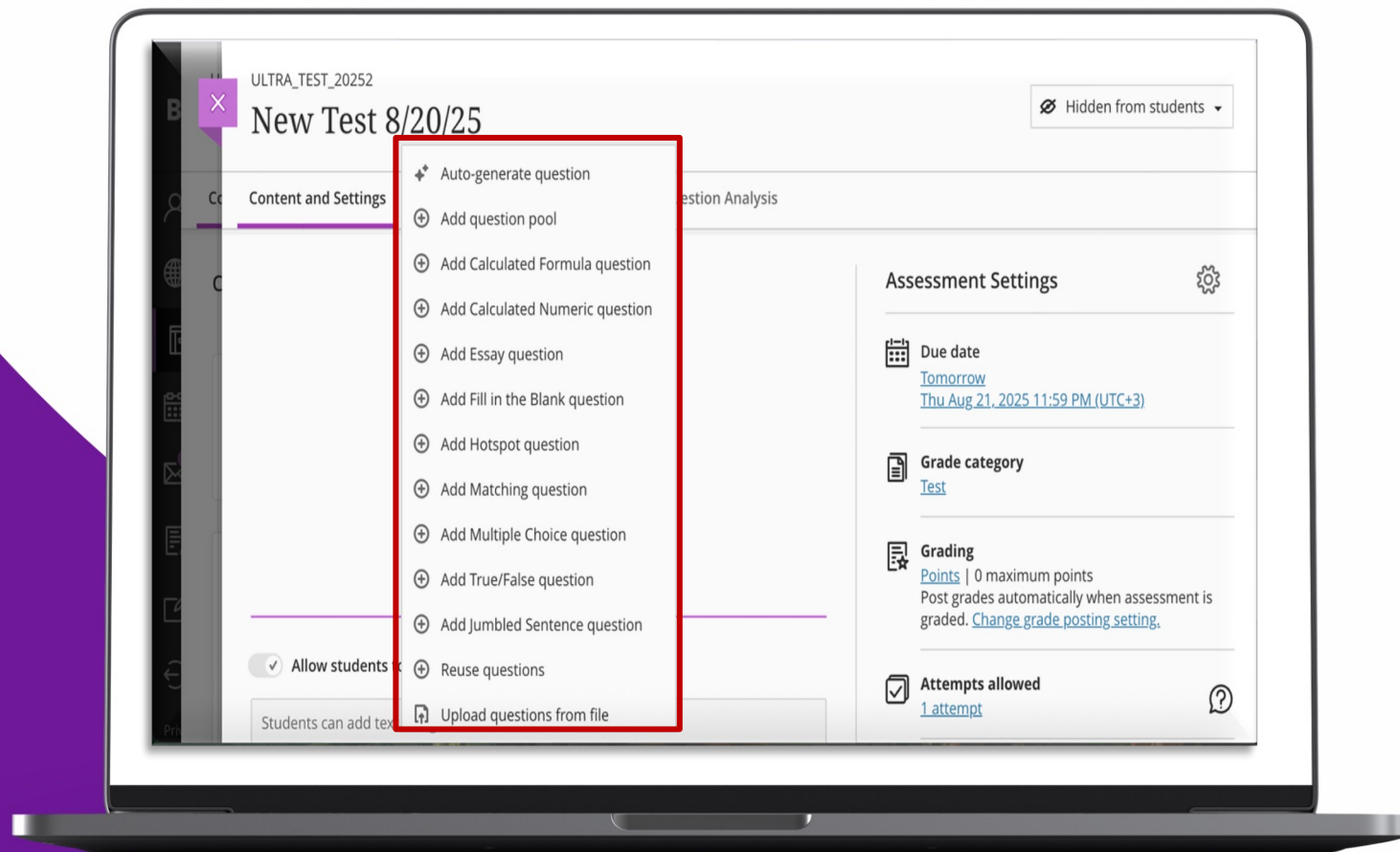

Select the Category of the Questions

1. Auto generated Questions

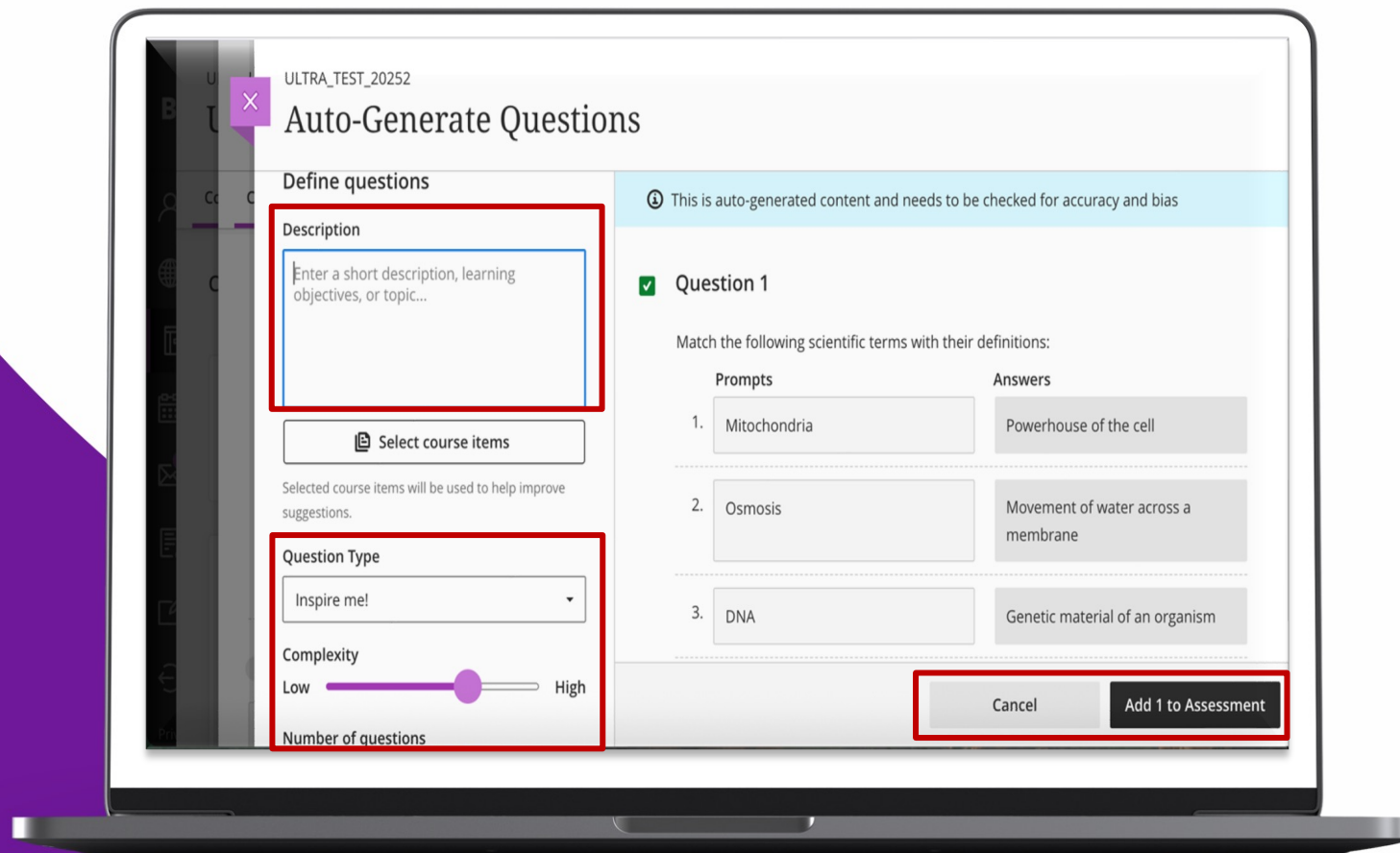

Click on **Auto-generated** to use Ai Features!

1. Enter Description : Guides AI to generate relevant questions based on the topic.
2. Select the Question Type : Choose the format like MCQ, true/false, etc.
3. Set the Complexity : Adjust difficulty level from easy to hard.
4. Set the Number of Questions: Define how many questions to generate using AI.

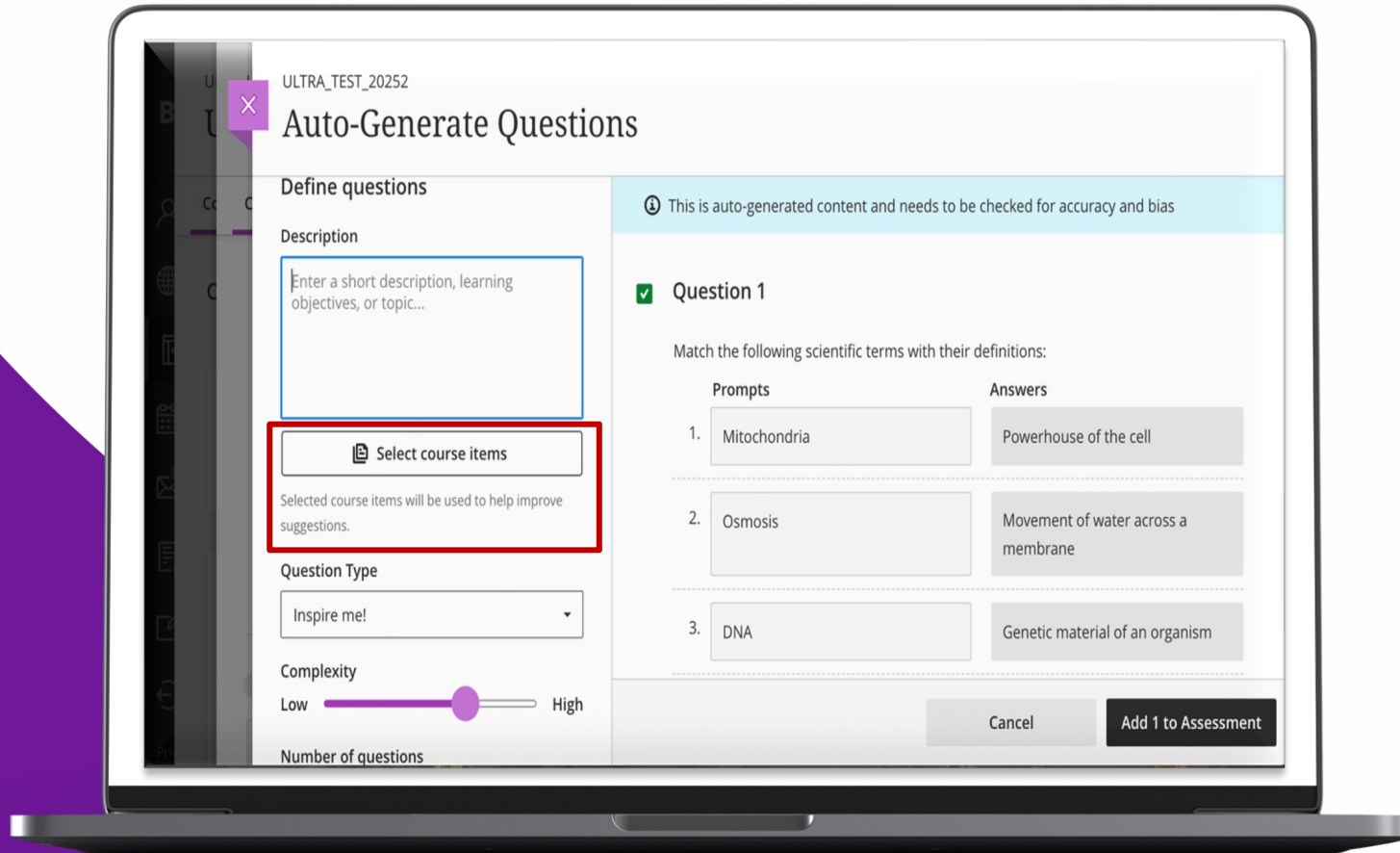

Select the Course Item

"Select Course Items" helps the AI understand what topics to focus on when generating test questions, ensuring the output is relevant to your course content.

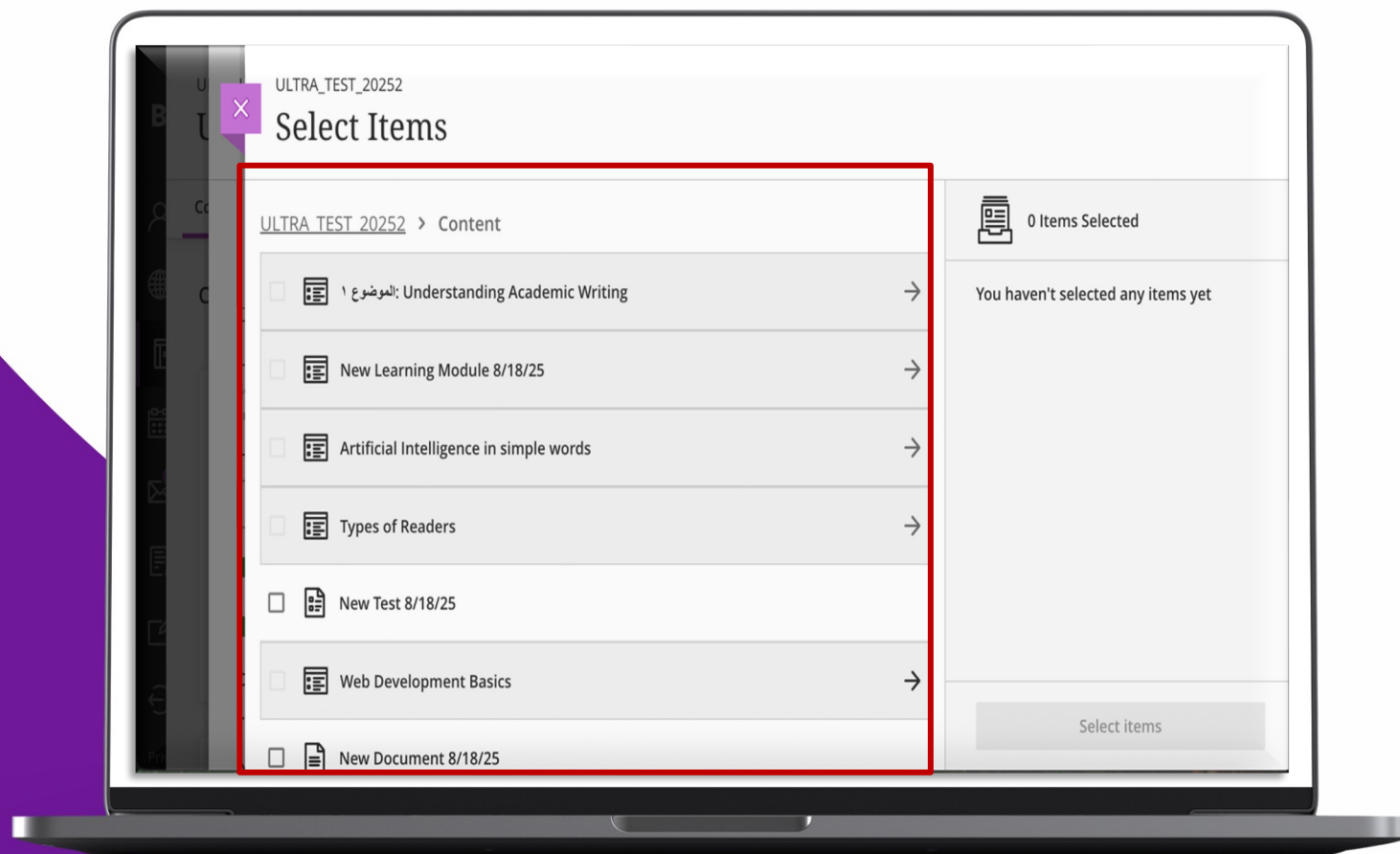

Select the Course Items

Selecting course items
helps AI generate
Questions that match
your existing content.

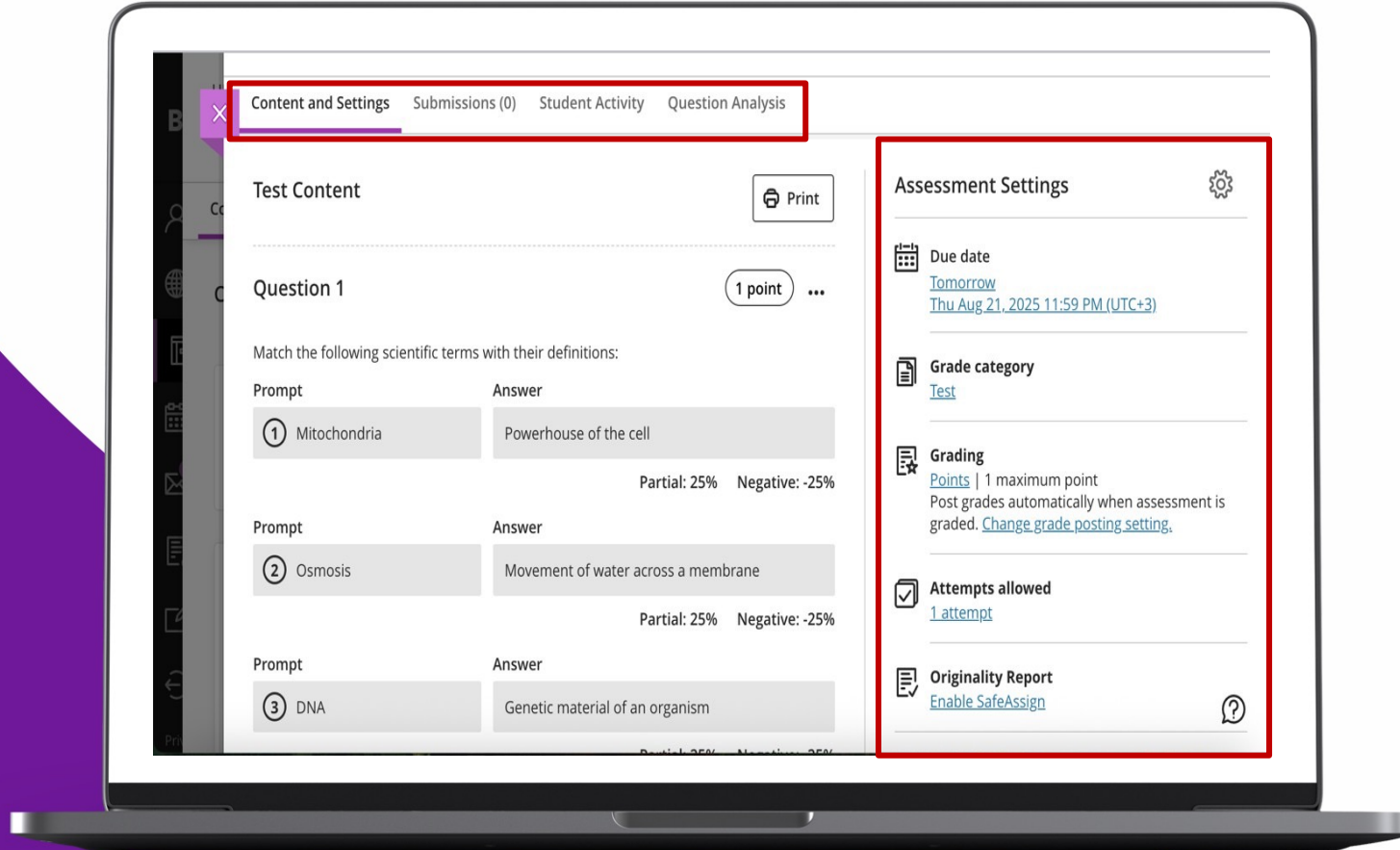

**After Adding the
Question, Assessment
Setting**

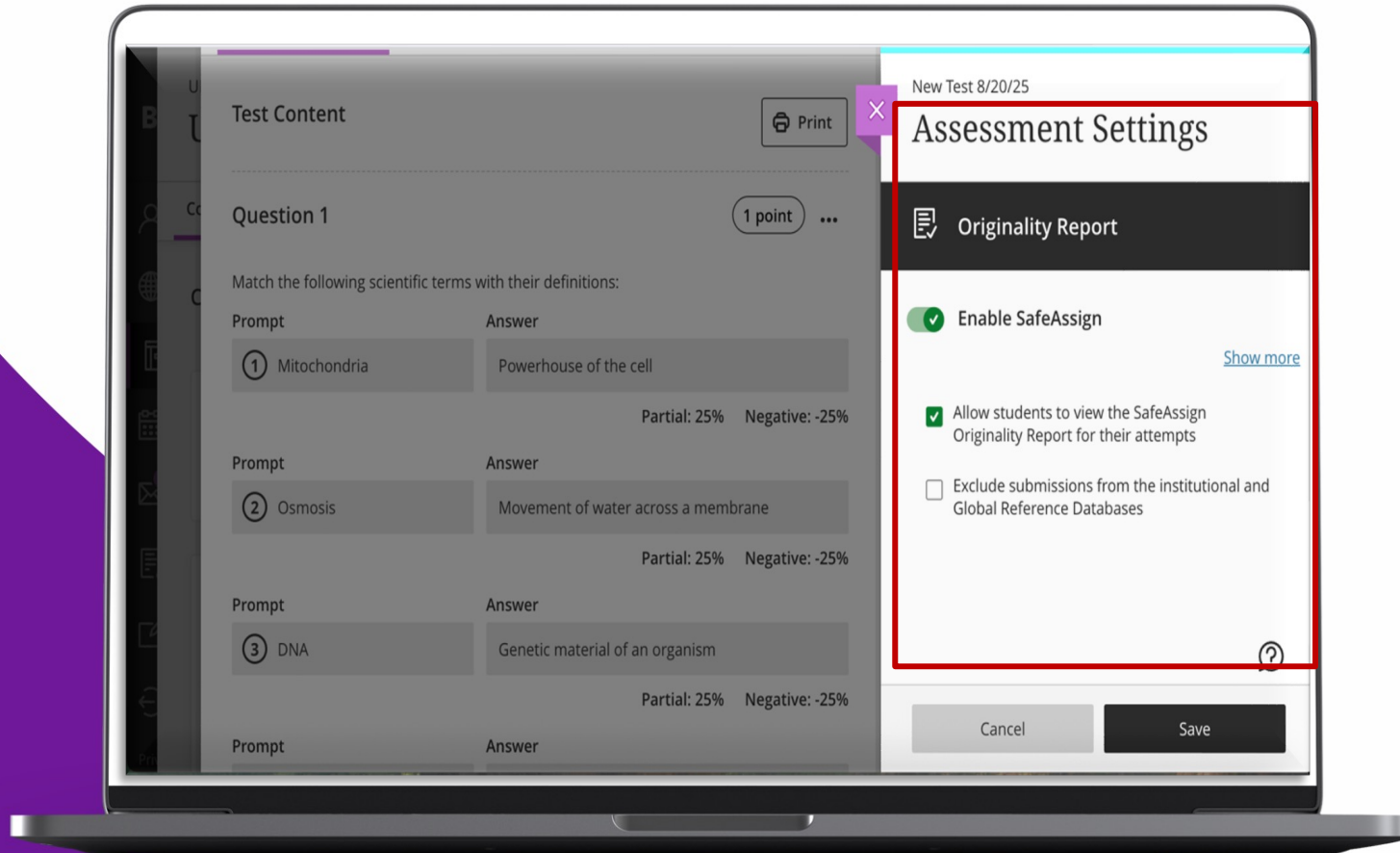

Enable the **SafeAssign** to
check the Plagiarism

Blackboard®



Jazan University
eLearning Center



✕ JazanU_ELC
elc@jazanu.edu.sa

